

AH3-A/AH3-B/AH3-C/AH3-D

<h1>STON</h1>	COMPACT SIZE POWER ON-DELAY MULTI-RANGE TIMER	泛用型 時間範圍四段式 限時繼電器
---------------	--	----------------------------------



AH3-□

- CE Approved by TUV MIKES.
- P&B or STON relays inside.
- Using MOTOROLA or TI CMOS IC.
- Multi-range & Contact can be changeable.
- 德國 TUV 實驗室 CE 認證。
- 內部採用美國第一品牌 P&B 或 STON 繼電器。
- 使用美國 MOTOROLA 或美國 TI 計時 IC。
- 可變化時間單位及接點。

◦ ORDERING INFORMATION 訂購說明

Ex. AH3 **B** **A220**

Timer type 型式	Timer range 時間範圍	Operating voltage 電壓範圍
A:AH3-A B:AH3-B C:AH3-C D:AH3-D	A 1S/10S/1M/10M	D12: DC12V
	B 3S/30S/3M/30M	D24: DC24V
	C 6S/60S/6M/60M	D48: DC48V
	D 1M/10M/1H/10H	A12: AC12V
		A24: AC24V
		A110: AC110V
		A220: AC220V
		A240: AC240V
		A380: AC380V
		A440: AC440V

◦ SPECIFICATIONS & CHARACTERISTICS 規格 & 特性

Type 型式	AH3-A AH3-B AH3-C AH3-D	
Rate operation voltage 額定電壓	DC: 12V/24V/48V AC: 12V/24V/110V/220V/240V/380V/440V	
Operating voltage range 電壓使用範圍	DC: 85%~110% AC: 80%~110%	
Rated frequency 額定頻率	AC: 50~60Hz	
Rated power consumption 額定功率消耗	About: 2VA	
Rated control capacity 輸出容量	DC: 5A 28VDC AC: 5A 250VAC P.F.=1	
Setting accuracy 設定誤差	± 10%	
Reset time 復歸時間	Less than 0.1s	
Life 壽命	Mechanical 機械	5000000
	Electrical 電氣	100000
Output arrangement 輸出方式	Timed-out 1 form C ◦ Instantaneous 1 form C / Timed-out 2 form C	
Max. temperature rise 最大溫升	55 deg.	
Ambient temperature 周圍溫度	-10°C to +65°C 但不結冰結露 But no ice	
Ambient humidity 周圍溼度	Max. 85% RH	
Weight 重量	About 120g	

AH3-A/AH3-B/AH3-C/AH3-D

◦ DIMENSIONS 规格尺寸

AH3-□

AH3-□ + Y-40

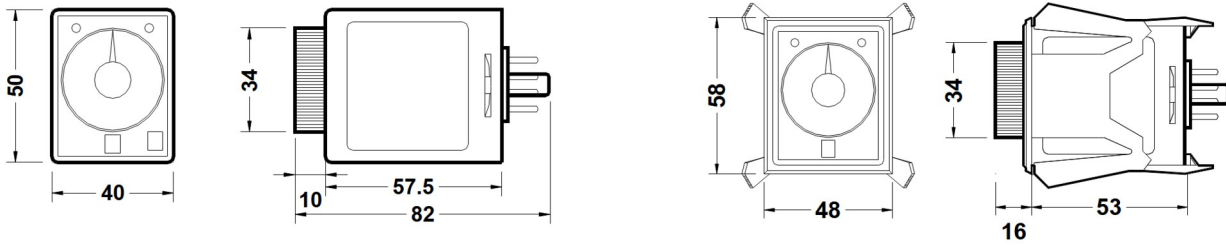

AH3-□ + PF085A

AH3-□ + US-08

AH3-□ + P3G-08

INSERT HOLE

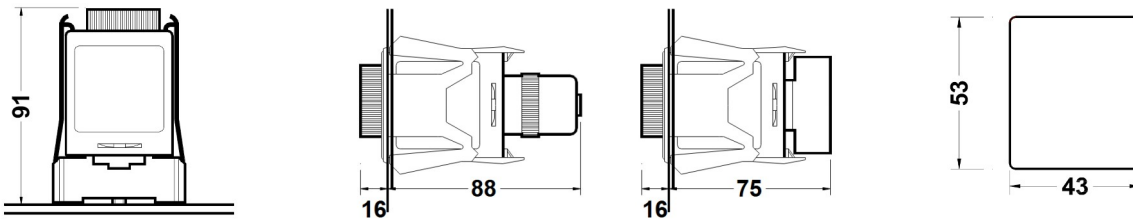

◦ OPERATION 操作方式

Mode A

Mode B

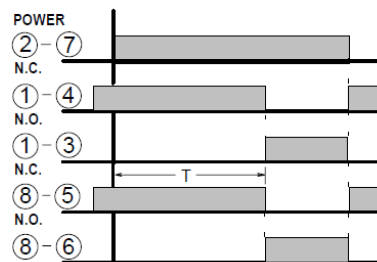
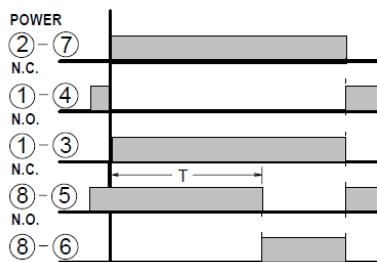
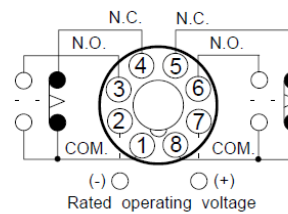
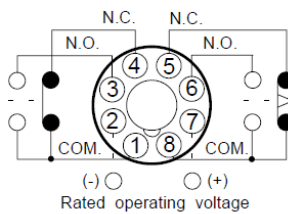

COM. : Common terminal
 N.C. : Normally closed contact
 N.O. : Normally open contact
 ● ▲ ● : Timed out contact
 ○ ○ : Instantaneous contact

- NOTE:
- Set time should be greater than min. operation time.
 - Once power is cut off or timing operation is completed, power off time is needed to start the operation again.
 - Do not change the set time during operation.
 - When changing set time, cut off power and set the time.